

# CABLE SEAL-2.5

## Pull up type security seal

### TECHNICAL SPECIFICATIONS

Material: **Steel + aluminium**

Closure: **with metal insert**

Tensile strength: **450 kg.**

Available colours: **blue**

Other colours and dimensions please check

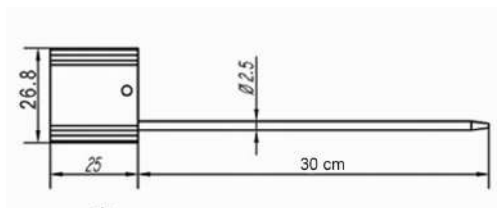
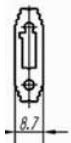

### TECHNICAL DETAILS

Printing Area: **25 x 18 mm.**

Strap section: **ø 2,5 mm.**

Lock length: **300 mm.**

Total length: **325 mm.**

### PRINTING OPTIONS

Consecutive numbering

Logo and/or text

Barcode

### PRINTING TECHNOLOGY

Laser

### PACKAGING

Quantity per box: 500 pcs.

Carton weight: 11,900 Kg.

Carton dimensions: 28 x 14 x 32 cm.

### APPLICATIONS

Trucks, containers, railways

